

# INSTALLATION GUIDE

## Round Base Piece for VidaMounts

### VB\_VESA\_MNT\_BP

Designed for Fixed & Flexible Surface VESA VidaMounts

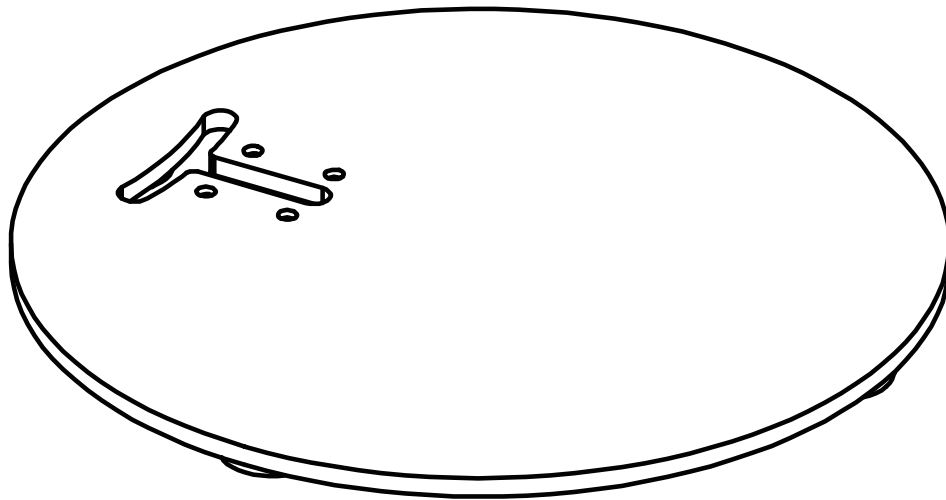

Compatible with:

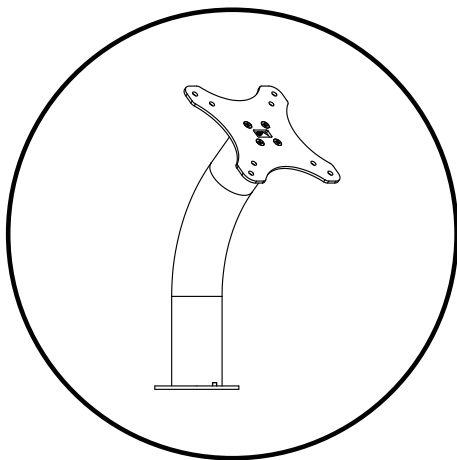

**VB\_VESA\_MNT\_FXS**  
Fixed Surface VidaMount

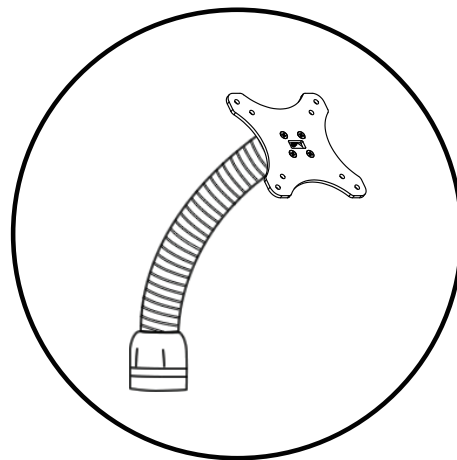

**VB\_VESA\_MNT\_FLX**  
Flexible Surface VidaMount

# Installation Instructions

## Round Base Piece for VidaMounts

### Important Note:

- If charging is desired, please prepare the extension cable and/or charging solution for the tablet mount first. Installing the charging solution / extension cable will be easier to do now than it will be to do later.
- This base piece is only compatible with the Fixed Surface VidaMount & Flexible Surface Mount.

### Component Checklist:

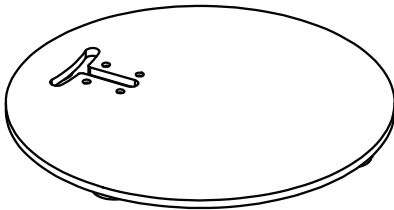

Round Base Plate

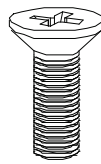

(4) M4x12 Phillips  
Countersink Head Screws

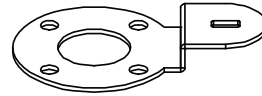

Kensington Lock Add-on  
(For use with Flexible Mount only)

### ① Assemble the Fixed or Flexible Surface Mount

Follow the originally included instructions, and assemble the fixed or flexible surface mount.

#### For Fixed Surface Mount

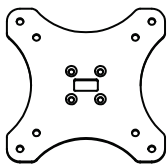

VESA Mounting  
Plate

+

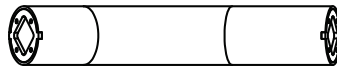

Fixed Neck Tube

+



(4) M4x12 Phillips  
Countersink  
Head Screws

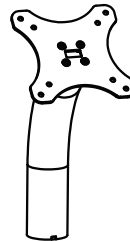

Fixed Surface  
Mount Assembly

#### For Flexible Surface Mount

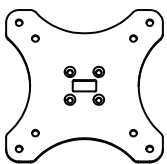

VESA Mounting  
Plate

+

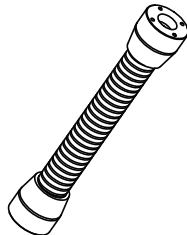

Flexible Neck  
Tube

+

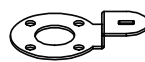

Kensington Lock Add-on  
[Optional & included with  
round base piece]

+



(4) M4x12 Phillips  
Countersink  
Head Screws

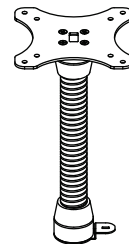

Flexible Surface  
Mount Assembly

## ② Install Round Base Piece onto the Bottom of the Assembly

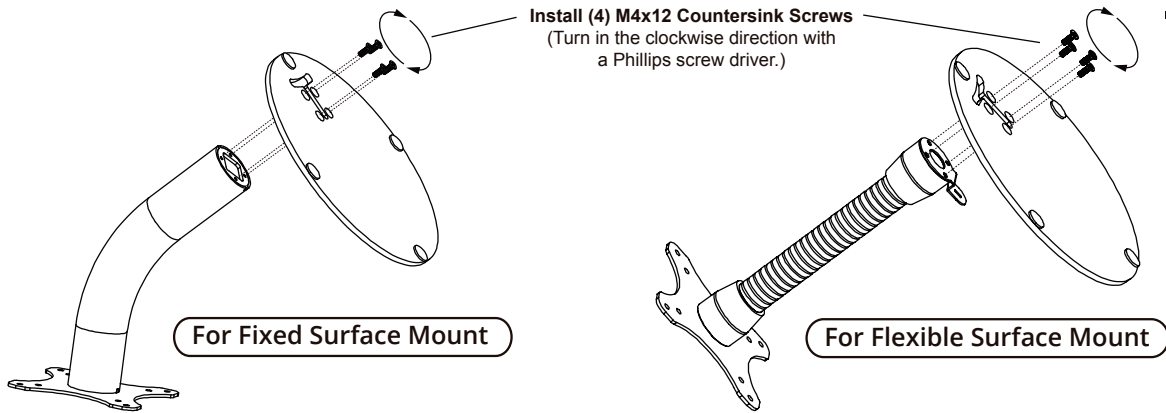

## ③ OPTIONAL : Install Kensington Lock

For security, one may wish to use the built-in Kensington security slot with a compatible Kensington lock (Sold separately, not included).

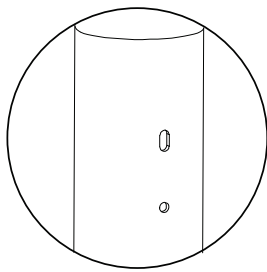

Kensington Slot  
(On Bottom Rear of Unit)

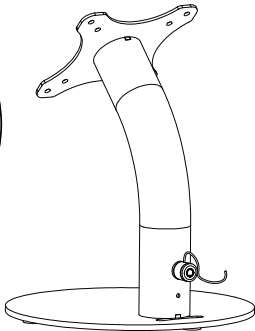

For Fixed Surface Mount

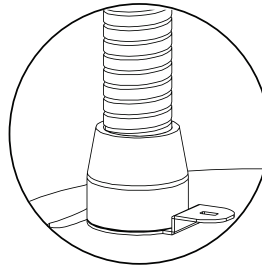

Kensington Slot  
(With Included Add-on)

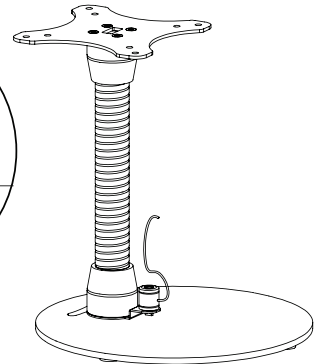

For Flexible Surface Mount

## Dimensions / Diagram

