

C Install "Cover" Piece onto "Base"

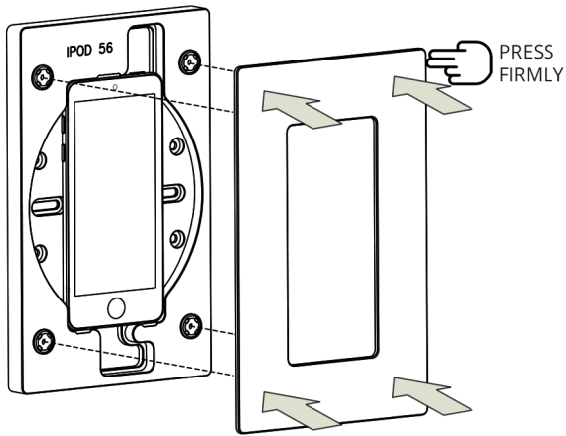

Lastly, align the separate cover onto the base. Be sure that the snap buttons are aligned.

PRESS FIRMLY until the cover snaps into place. We are now complete with the install!

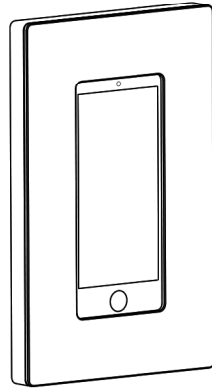

D Remove "Cover" to Access the Installed iPod

To remove the cover, simply apply pressure onto the edges of the cover, and lift away from the base.

The buttons will release the cover, allowing the iPod to be accessible.

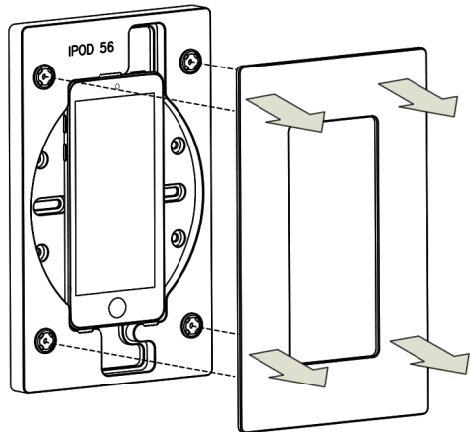

INSTALLATION GUIDE

VidaMount On-Wall Slim iPod Mount

VB_OWL_IPODT56

Direct wall or gang box mounting design, with easy iPod access

Includes (1) cover & (1) base piece to mount iPods onto walls, or onto US / EU / International electrical gangboxes

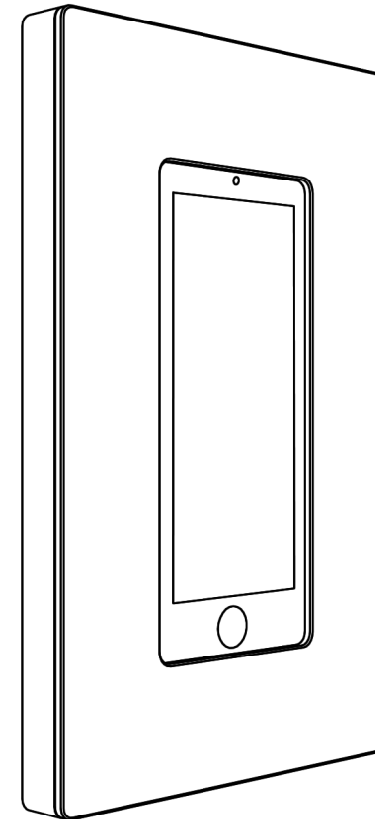

NOTE: Illustrations may vary slightly from finished part.

Installation Instructions

VidaMount On-Wall Slim iPod Mount

Important Note



This kit includes the BASE + COVER of the wall-mount enclosure. Appearance and size of the BASE + COVER may vary from the illustrations. The only iPod that will fit this enclosure are the iPod Touch 5th and 6th gen models. The enclosure is custom fitted - it cannot fit other iPod models!

Component Checklist

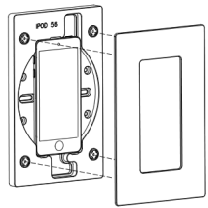

iPod Mount
Base & Cover
(iPod not included)

For US Gang
Box Mounting



(4) #6-32 x 1"
Pan Head Screws

EU / Intl Gang
Box Mounting



(2) M3.5 x 25mm
Pan Head Screws

For direct wall mounting, use self-supplied screws & anchors

START HERE Decide How to Install the iPod Mount

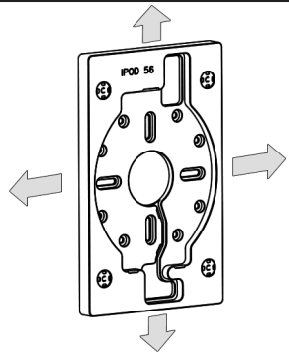

WALL SURFACE

For Gang Box Installation: Skip to **(A)**
(Recommended method - See page on right)

For Direct On-Wall Installation:
Place the BASE piece onto the wall,
where we plan to permanently affix it.

Be sure you are happy with its position
before proceeding further.

DO NOT AFFIX / INSTALL THE
BASE ONTO THE WALL YET.

1 On-Wall Installation: Mark Anchor Positions with Screw

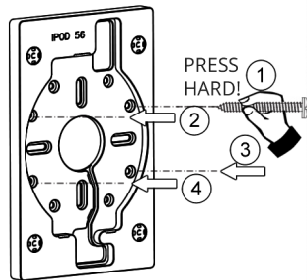

PRESS
HARD!

With the BASE piece positioned where
you'd like it to be installed, use your
choice of wall screw, and use it to mark
the (4) anchor / mounting locations.

Push the screw FIRMLY into the (4)
anchor positions so that an imprint is
left on the wall.

2 On-Wall Installation: Install Wall Anchors

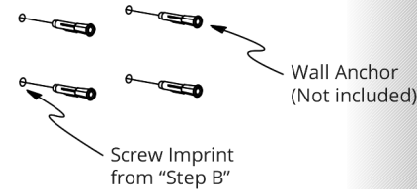

With the (4) anchor positions marked, install
(4) wall anchors [Not included / self-supplied]

3 On-Wall Installation: Install "Base" Piece

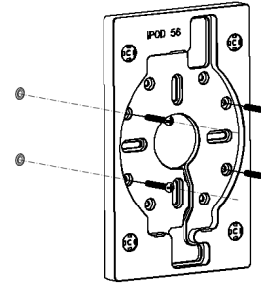

For Wall Installation:
Using (4) wall screws [Not included /
self-supplied], install the BASE piece
onto the wall now.

Install the iPod into the Mount now, and
Skip to **(C)**

REMEMBER:
For charging, you'll need to remove the iPod!

A Gang Box Installation: Install "Base" Piece



Installed Gangbox
(Not included)

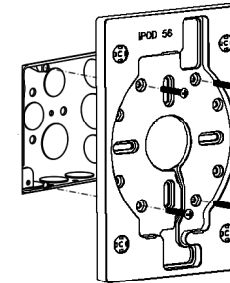

For Gang Box Installation:
Place the enclosure over the
center of the electrical gang
box to align the screw holes.

In the aligned screw holes,
install the appropriate screws
and secure the enclosure to
the gang box.

B Gang Box Installation: Connect Power, Install iPod

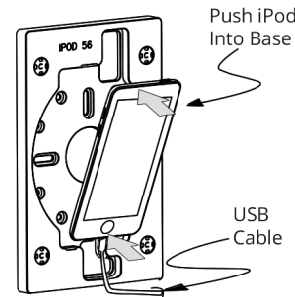

OPTIONAL: If a power solution is in place,
connect the iPod's lightning cable now to
confirm it's working.

Afterwards, install the iPod into the BASE
piece, as shown on the left.